



Saves Your Energy

PRODUCT CARD

26.5.2019

1/2

SAL4.27

Name: **Mechanical cable lug**
Al/Cu 150-300 mm² ø 13 mm

Type: SAL4.27

GTIN: 6418677401503

Description: The cable lugs are used for terminating conductors of up to 1 kV cables. Because of the shear head bolt construction no crimping tools are needed. The required torque is achieved by tightening the bolt until it breaks off. The lugs are longitudinally water tight and they are suitable both for aluminium and copper conductors, solid and stranded, sector shaped and circular.

Package: 50/2250

Unit: PCS



Photo presented is indicative only

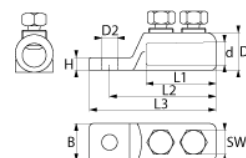

Technical specification

Ratings

ETIM 7 EC001054

Dimensions

Weight 0.32 kg

Nominal cross section 150 ... 300 mm²

Conductor size Al 150 ... 300 mm²

Conductor size Cu 150 ... 300 mm²

Drawing markings

B 42 mm

d 25 mm

D1 42 mm

D2 13 mm

H 13 mm

L1 71 mm

L2 111 mm

L3 132 mm

SW 22 mm

ETIM

Nominal cross section copper, RM 150 ... 300 mm²

Nominal cross section copper, RE 150 ... 300 mm²

Nominal cross section copper, SM 150 ... 300 mm²

Nominal cross section aluminium, RM 150 ... 300 mm²

Nominal cross section aluminium, RE 150 ... 300 mm²

Ensto Finland Oy

Ensio Miettisen katu 2
P.O.Box 77
06101 Porvoo, Finland

Tel. +358 204 76 21
Fax +358 204 76 2770

www.ensto.com



Saves Your Energy

PRODUCT CARD

26.5.2019

2/2

SAL4.27

Nominal cross section aluminium, SM	150 ... 300 mm ²
Nominal cross section aluminium, SE	150 ... 300 mm ²
Bolt dimension metric (M..)	22
Material conductor	Aluminium/copper
Surface protection	Tinned
With shear-off head	x

Ensto Finland Oy

Ensio Miettisen katu 2
P.O.Box 77
06101 Porvoo, Finland

Tel. +358 204 76 21
Fax +358 204 76 2770

www.ensto.com